

Carbon Monoxide Detector-Transmitter E2608-CO



Features

- Wall-mount or duct-mount version
- Industrial IP65 housing
- Two relays for alarm / ventilation control
- Two analog outputs settable to 4-20 mA or 0-10 V
- RS485 Modbus RTU digital interface
- Attached or remote sensor

Specifications

Calibration	Carbon Monoxide CO
Sensing method	long-life electrochemical cell
Sampling method	diffusion
Detection range	0...1000 ppm CO
Maximum overload	2000 ppm
Resolution	1 ppm CO
Repeatability	< ± 5 %
Signal update	every 1 second
Response time	<30 seconds
Maintenance interval	6 months
Sensor lifetime	> 6 years
Self-diagnostics	full functionality check at start-up
Warm-up time	≤ 1 min
Power supply	11...30 VDC, 24 VAC or 90...265 VAC
Power consumption	< 2 VA
Digital interface	RS485, Modbus RTU protocol
Analog outputs	2 × 4-20 mA / 0-10 V, user settable
Output scale width	recommended: 5-100% of the range; > 10 × resolution in any case
Output relays	2 × SPST relays (closing contact), 250 VAC / 30 VDC, 5 A max
Default alarm set-points	RE1 (LOW): set 25; release 20 ppm RE2 (HIGH): set 35; release 28 ppm
Enclosure	light grey ABS plastic, wall mount, protection class IP65
Dimensions	H85 × W82 × D55 mm
Remote sensor probe	protection IP65, shielded cable default cable length 3.0 m
Operating environment	industrial indoor and outdoor locations
Operating conditions	-20...+50 °C, 15...95 %RH pressure 0,9...1,1 atm non ATEX rated areas

NOTE The sensor may exhibit sensitivity to acetylene, ethylene, hydrogen and nitric oxide

Ask for other versions or custom designed products

Wall mount version

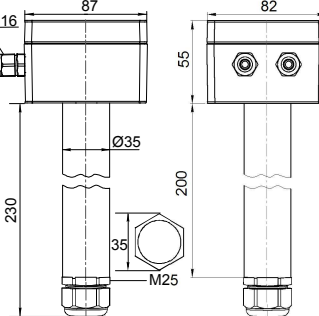
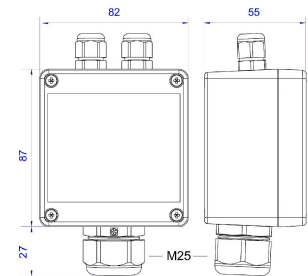

Duct mount version

Connection diagram

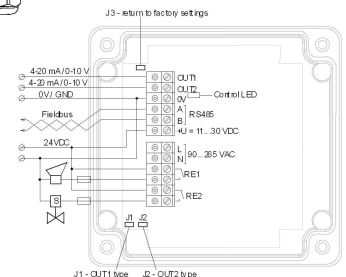

Remote probe

