

# Chlorine Detector-Transmitter E2608-CI2



## Features

- Wall-mount or duct-mount version
- Industrial IP65 housing
- Two relays for alarm / ventilation control
- Two analog outputs settable to 4-20 mA or 0-10 V
- RS485 Modbus RTU digital interface
- Attached or remote sensor

## Specifications

Detected gas	Chlorine Cl <sub>2</sub>
Calibration	Chlorine Cl <sub>2</sub>
Sensing method	Electrochemical
Sampling method	Diffusion
Typical detection range	0...10 ppm
Maximum overload	100 ppm
Resolution	0.1 ppm
Signal update	Every 1 second
Response time	<60 seconds
Maintenance interval	6 months
Sensor lifetime	>2 years
Self-diagnostics	Full functionality check at start-up
Warm-up time	≤ 1 min
Power supply	11...30 VDC, 24 VAC or 90...265 VAC
Power consumption	< 2 VA
Digital interface	RS485, Modbus RTU protocol
Analog outputs	2 × 4-20 mA / 0-10 V, user settable
Output scale width	recommended: 20-100% of the range; > 10 × resolution in any case
Output relays	2 × SPST relays (closing contact), 250 VAC / 30 VDC, 5 A max
Default alarm set-points	LOW: set 0.5 ppm, release 0.4 ppm HIGH: set 1 ppm, release 0.8 ppm
Enclosure	Grey ABS plastic, wall mount, protection class IP65
Dimensions	H85 × W82 × D55 mm
Remote sensor probe	protection IP65, shielded cable default cable length 3.0 m
Operating environment	industrial indoor and outdoor locations
Operating conditions	-20...+50 °C, 15...90 %RH, pressure 0,9...1,1 atm non ATEX rated areas

**NOTE** The sensor may exhibit sensitivity to hydrogen sulfide

Ask for other versions or custom designed products

### Wall mount version

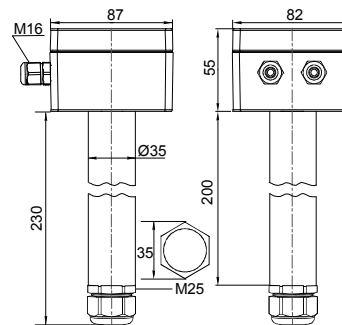
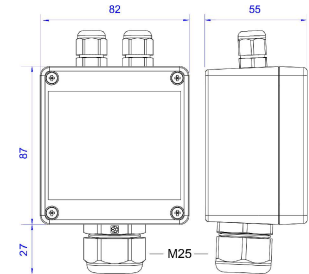

### Duct mount version

### Connection diagram

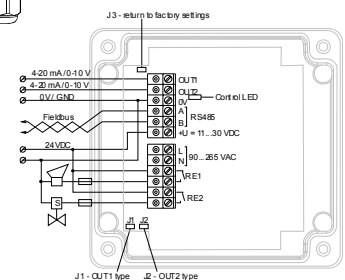

### Remote probe

